

VENT ROLL PANEL VENT G502

DESCRIPTION

The VENT Roll Panel Vent G502 is designed to maintain a continuous 25mm air gap between the underside of the roofing membrane or sarking board and loft insulation at the eaves, providing a consistent flow of air into the roof space.

FEATURES

- The extra width of the panel allows for better coverage when low pitch and deep insulation details are encountered.
- Suitable for new builds or renovations.

SCOPE OF USE

- Should be used in conjunction with other soffit/fascia vents to provide a complete passive ventilation system.
- Should be used as part of proprietary system for trussed roof design.
- To be used as part of proprietary ventilation system.

WARRANTY

- 30 years

MAINTENANCE

- No maintenance requirements.

INSTALLATION

1. Lay the castellated profile across the top of the roof trusses/rafters.
2. It should be rolled out the full length of the eaves and adjusted to align with the required roof truss centres.
3. Nail or staple to secure in position as shown.

G502 Roll Panel Vent

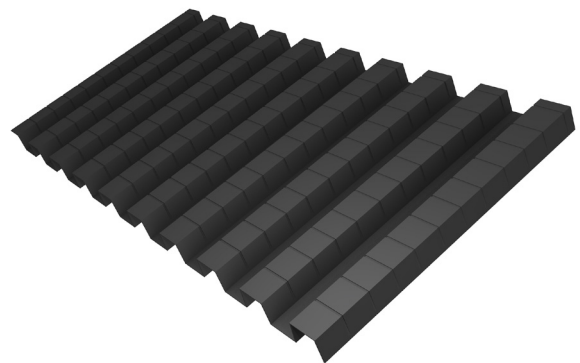

VENT ROLL PANEL VENT G502

Fig A: Application with G2500N Over Fascia Vent, trussed roof pitched <math><15^\circ</math>

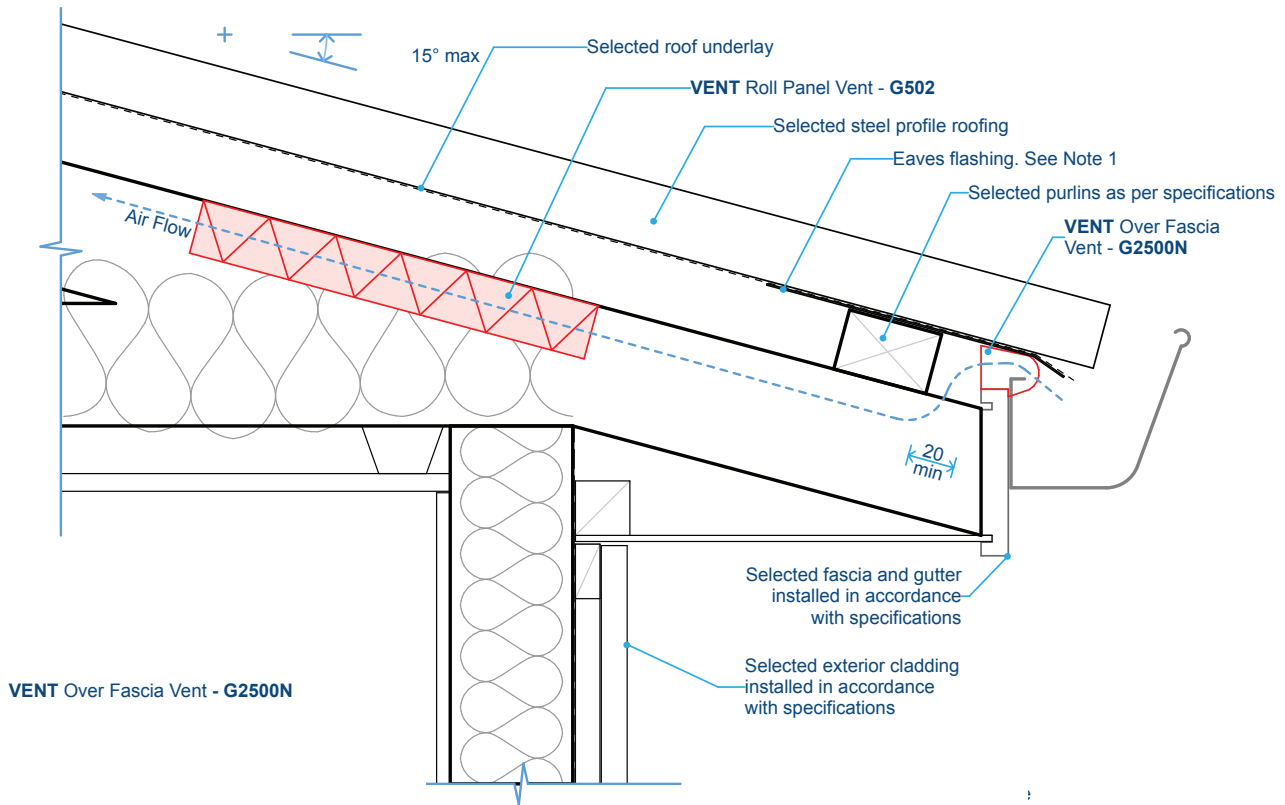

VENT ROLL PANEL VENT G502

Fig B: Application with G2500N Over Fascia Vent, trussed roof pitched <math><15^\circ</math>

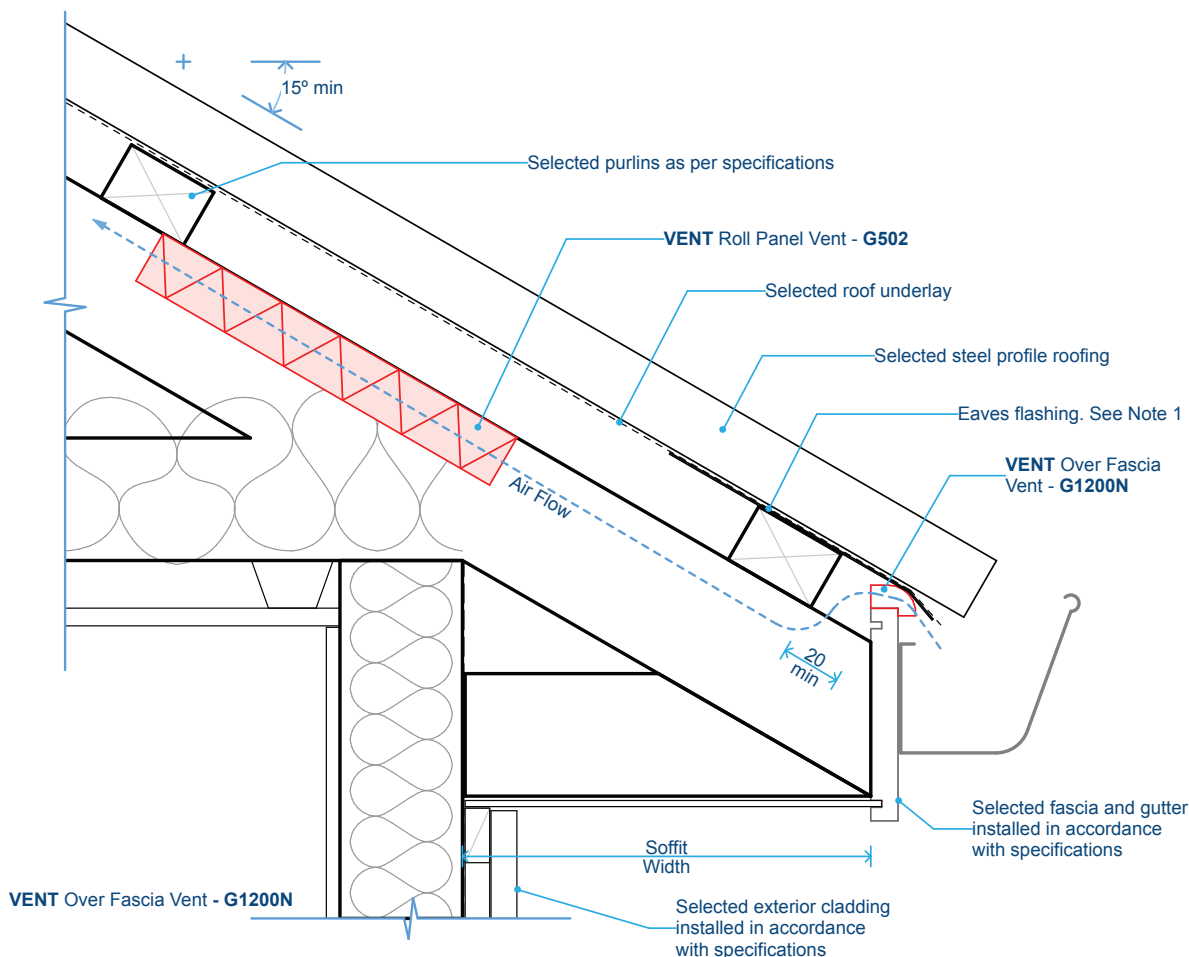

Note: Diagrams are for guidance purposes only. The overall design is the responsibility of the designer as there are often other factors to consider. The company maintains a policy of continuous development of its product range and reserves the right to amend the specification without notice.